

1. Номинальное напряжение, 110кВ
2. Минимальная механическая разрушающая сила при изгибе, 6кН
3. Длина пути утечки, 2230мм, не менее
4. Цвет: коричневый
5. Применяемый стандарт: МЭК 50168 & МЭК 60273

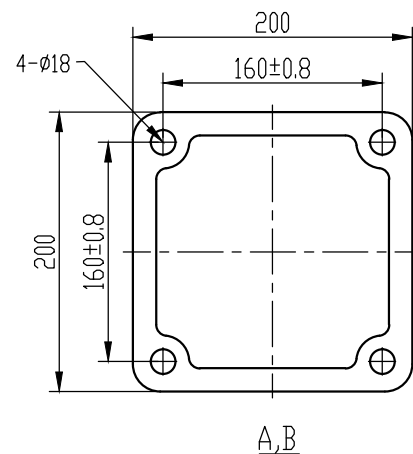

TECHNICAL REQUIREMENTS

1. Nominal voltage: 110kV
2. Cantilever strength 6kN
3. Leakage distance 2230mm
4. Unless specified ACC. TO IEC 60168 & KDOP757522.001.TU
5. Before reinforcement porcelain and fitting surface contacting with reinforcing agent , should be covered evenly with lacquer
6. Fitting coating H. D. G
7. Cement joint coating Silicone sealant
8. Insulator should correspond to KDOP. 757522. 001 TU requirements

5	F21021	FITTING	1	QT450-10			
4	3053-1	PORCELAIN	1	IV			
3		CEMENT					
2		CORK	1				
1	F21021	FITTING	1	QT450-10			
№	DRAWING №	NAME	QTY	MATERIAL	ONE WEIGHT	TOTAL WEIGHT	NOTE

				DRAWING № 3053		
				ИОС-110-600		
				PHASS SIGN	WEIGHT	SCALE
						1:7
				TOTAL 2 PAGES		PAGE 1
SIGN	QTY	REJIGGER №	NAME	DATE	INSULATOR	
DRAWN						
CHECKED						
APPROVE				MATERIAL		
DATE						

